

N° 975 NBR60N

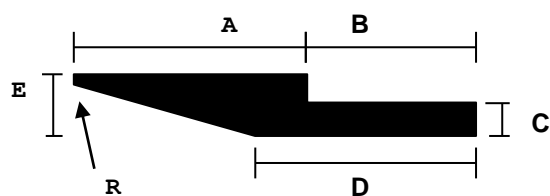

N°	MATIERE	A	B	C	D	E	F	G
978	NBR60N	150	7.5	2.5	5	103	42.5	4
976	NBR60N	150	13.5	2.5	5	103	42.5	12
977	NBR60N	180	7.5	2.5	5	133	42.5	4
979	NBR60N	180	13.5	2.5	5	133	42.5	12

N°	Matière	A	B	C	D	E	R
986	CR60N	49	40	5	45	11	0.5
1294	CR60N	45	40	5	45	11	0.5

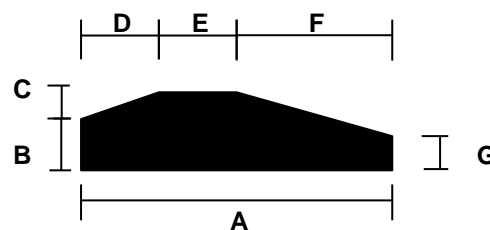
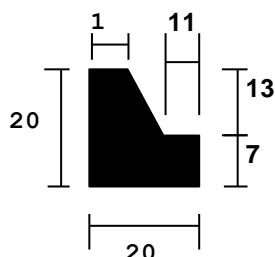

N° 345 NR70N

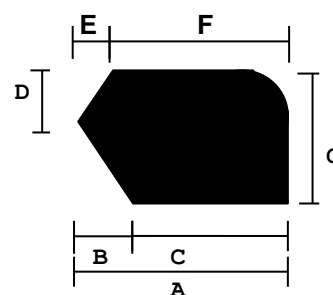

N°	MATIERE	A	B	C	D	E	F	G
188	CR40N	27	4	23	3	3	24	8
190	CR40N	33	4	29	3	3	30	8
192	CR40N	19	3	16	3	3	16	8
194	CR40N	23	4	19	3	3	20	8

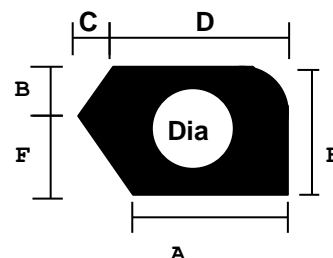
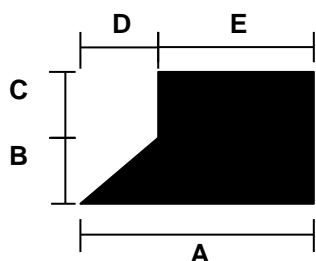

N°	MATIERE	A	B	C	D	E
404	NR70N	9	2	1	1	8
397	CR60N	28	8	10	17.5	10.5
647	NR85N	9	2	8	4	5

N°	MATIERE	A	B	C	D	E	F	Dia
189	CR40N	23	3	3	24	18	15	8
625	NBR60N	23	3	3	24	18	15	8
1034	NBR50N	23	3	3	24	18	15	12
1066	CR60N	27	7	7	24	23	16	8
193	CR40N	29	3	3	30	18	15	8

Attention , planche évoluant constamment . Nous consulter systématiquement