

F 1132 EPR 50 N

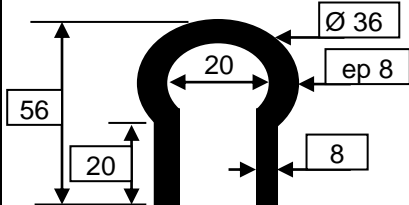

F 124 CR 60 N

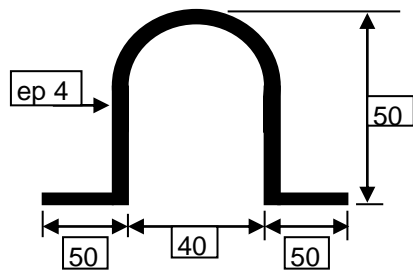

F 442 EPR 55 N

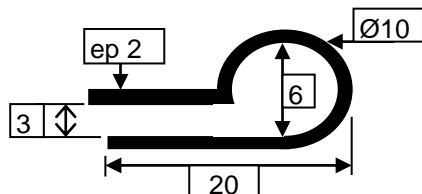

F 157 NR 60 N

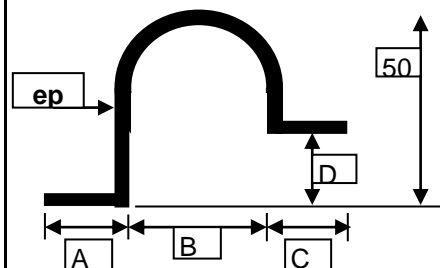

N°	MATIERE	A	B	C	D	ep
F 658	EP 55N	50	40	50	25	4
F 1312	EP 55N	30	40	60	15	3

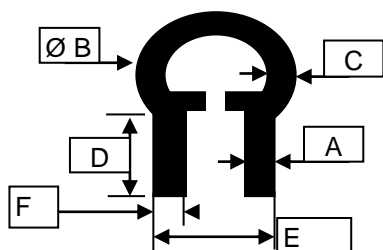

N°	MATIERE	A	Ø B	C	D	E	F
436	CR70N	10	36	3	18	25	10
828	NR55N	10	36	3	20	25	7.5