

N°	MATIERE	A	B	C	D	R
326	NR70N	20	5	2	15	Vif
81	NR70N	25	9	2.5	16	Vif
360	CR60N	25	10	3	15	Vif
1205	EPR50N	25	20	5	5	Vif
855	NR60N	50	25	5	25	Vif
327	NR40M	55	20	4	35	4
1402	CR70N	60	25	8	35	2
1189	CR70N	90	30	12	60	Vif
1430	CR60N	63	25	8		Vif

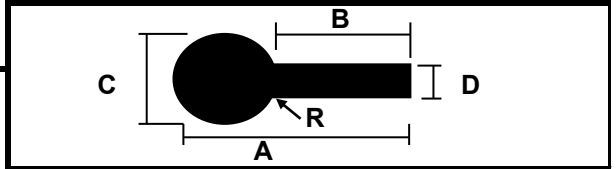

N°	MATIERE	A	B	C	D	R
1188	NBR90N	13	4	9	7	Vif
919	EPR50N	15	10	5	2	Vif
465	NR50N	28	14	10	3	10

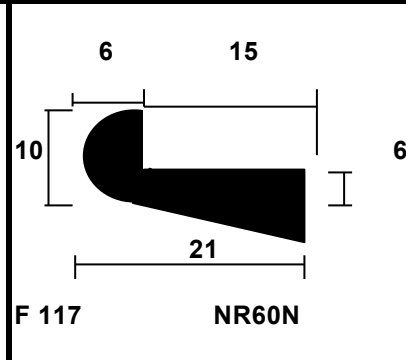
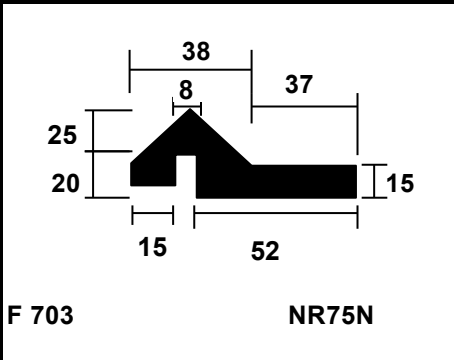
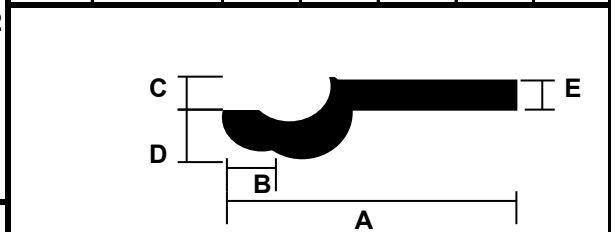
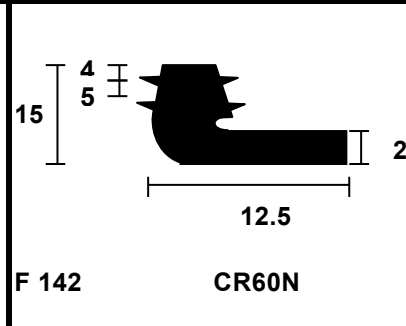
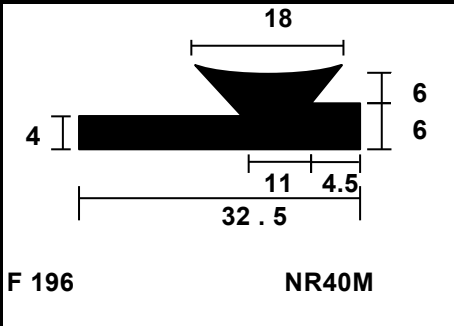
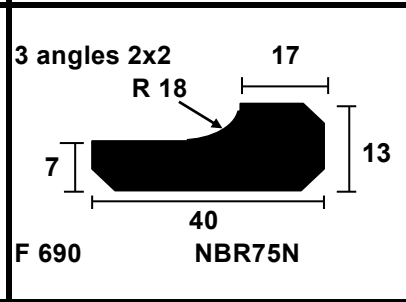
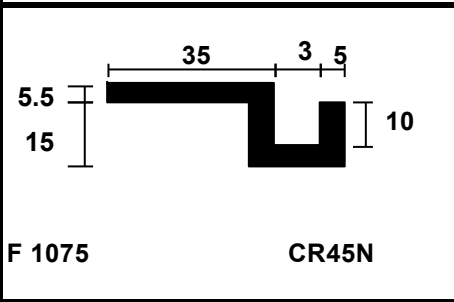

N°	MATIERE	A	B	C	D	E
323	NR60N	25.5	1	2	6	2
68	NR70N	26.5		5	2.8	1.5

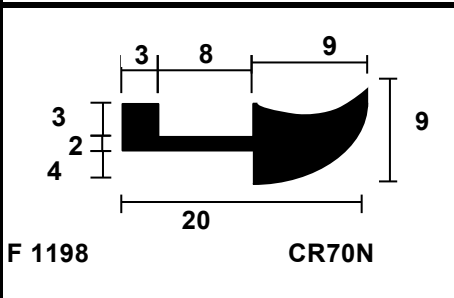

Attention , planche évoluant constamment . Nous consulter systématiquement